

INSTALLATION INSTRUCTIONS BUMPER GUARD SYSTEMS BGL-4

STORAGE, HANDLING & ENVIRONMENTAL CONDITIONS:

1. All materials shipped unassembled. Store vertically or on flat horizontal surface.
2. Begin installation only after finish construction has been completed and building interior has been within temperature range intended for continued use for at least 24 hours. Cut vinyl and aluminum components to fit only after they have been at temperature intended for continued use for 24 hours.

INSTALLATION:

1. Measure and mark fastener centerline on wall or partition. Locate this centerline by subtracting 2-1/16" [26.99mm] from height of top of rail on wall or partition.
2. Measure and mark retainer ends on wall or partition (see Standard Plan Detail).
3. Measure and mark retainer fastener holes on wall or partition. Locate holes on fastener centerline 32" [812.8mm] O.C. max., unless otherwise specified or shown, and at distances from retainer ends as shown (see Standard Plan Detail).
4. Pre-drill fastener holes in wall or partition at locations marked. Make hole diameter as small as possible, allowing for fasteners. For most drywall applications, we recommend 1/4"-20 bolts and 1/4" size BB strap-type Toggler brand toggles by Mechanical Plastics. For most masonry applications, we recommend 1/4" lag screws and Toggler brand "alligator" anchors, size A6, by Mechanical Plastics.
5. Pre-drill holes in retainer lengths to align with holes in wall or partition. Make holes as small as possible, allowing for fasteners.
6. Assemble retainers. Insert tabs on end caps into retainers, clamp into place and secure with #8x1/2" sheet metal screws.
7. Secure rail assemblies to wall or partition. Assemble fasteners, insert through holes in retainer and bumper cushions and into holes in wall or partition, and secure per fastener manufacturer's printed instructions.
8. Install cover. Secure cover to retainer by hooking over retainer top and snapping over retainer bottom. Make all joints neat and hairline tight.
9. Use mild detergent to clean soiled surfaces. Do not use powdered cleansers, as they may leave a residue embedded in cover surface.

PARTS LIST BGL-4

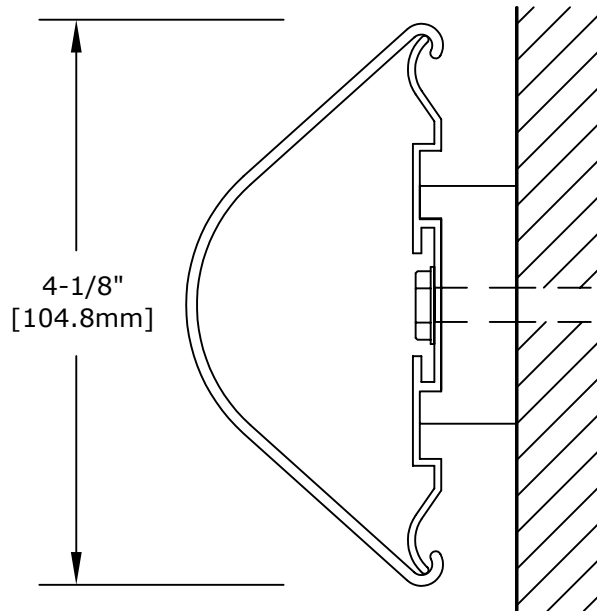

ALUMINUM RETAINER - #A017
VINYL ACRYLIC COVER - #V109
END CAP - #M263
BUMPER CUSHION - #M284
#8 X 1/2" S.M.S. - #A300

COVER INSTALLATION

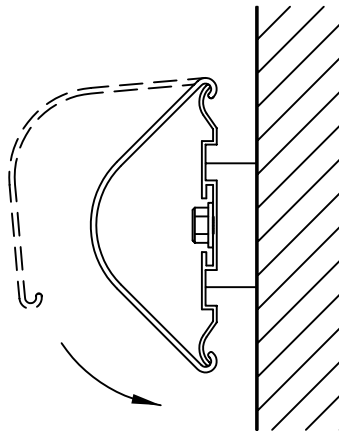

1. HOOK OVER TOP OF RETAINER.
2. ROTATE DOWNWARD, PUSHING FIRMLY TO SNAP OVER RETAINER BOTTOM.

ASSEMBLY DRAWING

BGL-4

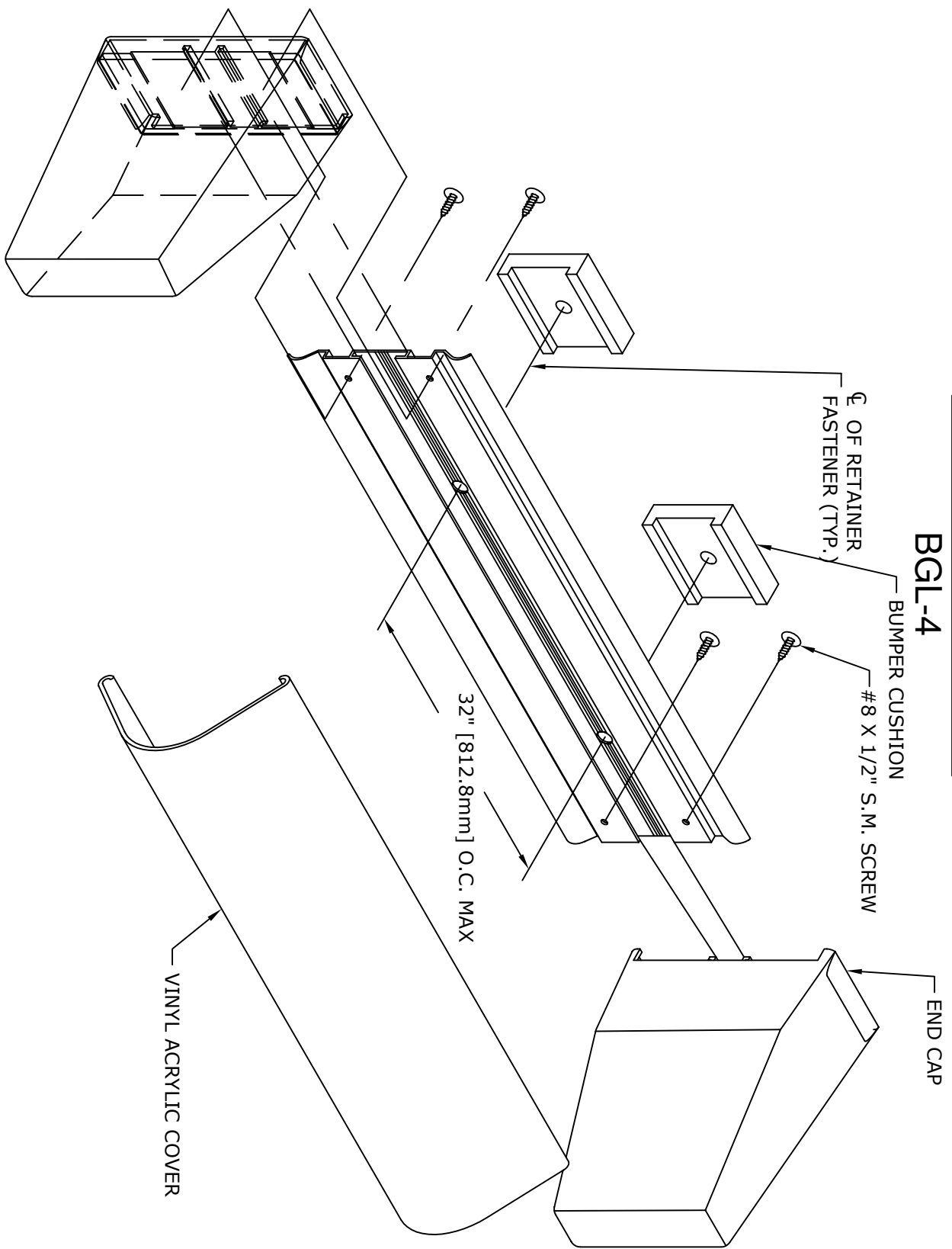

Arden
Architectural
Specialties, Inc.™

151 FIFTH AVE. NW SUITE J ST. PAUL, MN 55112-3268
TOLL-FREE 800.521.1826 TEL 651.631.1607 FAX 651.631.0251

STANDARD PLAN DETAIL

BGL-4

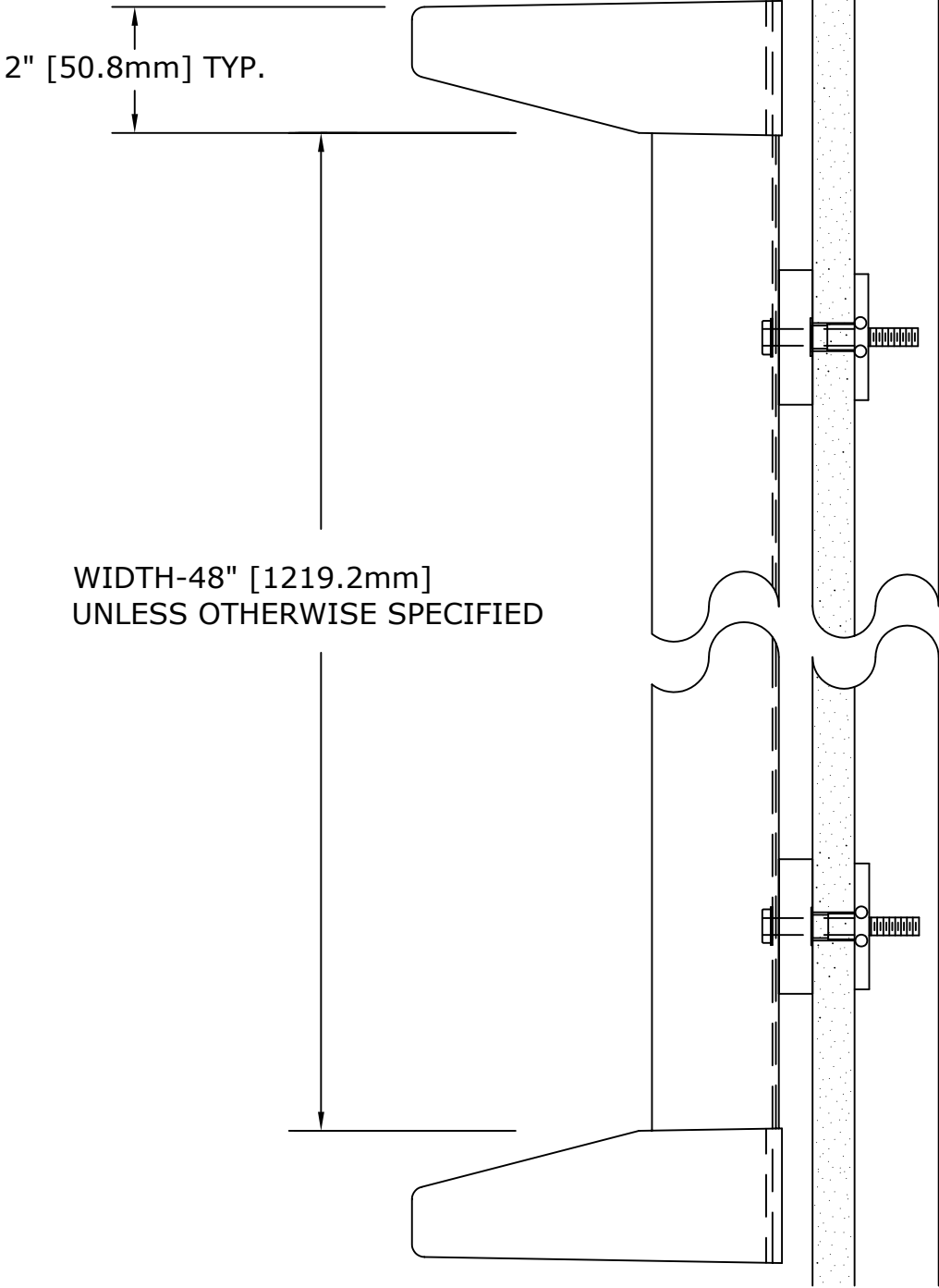

FASTENER HEIGHT BGL-4

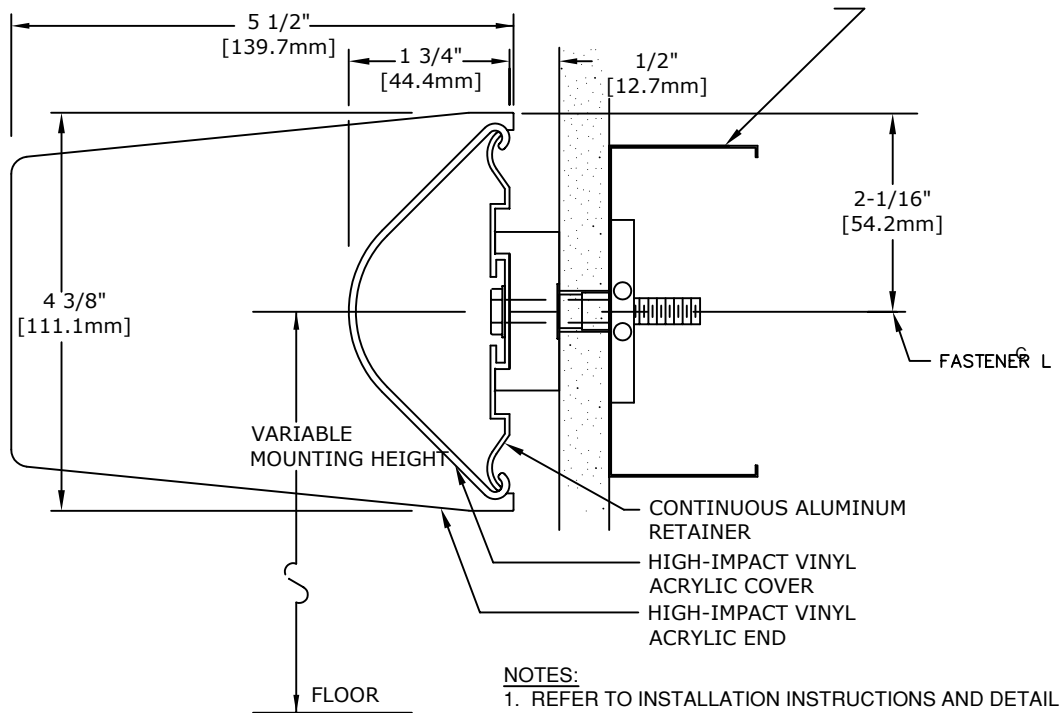

- NOTES:**
1. REFER TO INSTALLATION INSTRUCTIONS AND DETAIL SHEETS FOR MORE INFORMATION, INCLUDING PART NUMBERS.
 2. ON WALL OR PARTITION, MARK HEIGHT OF TOP OF RAIL (FROM FINISH FLOOR), THEN SUBTRACT DISTANCE FROM TOP OF RAIL TO FASTENER CENTERLINE.

IMPORTANT: USER SHALL VERIFY CONFORMANCE OF ALL CONSTRUCTIONS SHOWN WITH LOCAL CODES AND WITH REQUIREMENTS OF METAL STUD MANUFACTURER FOR RATINGS. FASTENERS AND PARTITION COMPONENTS NOT BY ARDEN ARCHITECTURAL SPECIALTIES, INC.

TYPICAL FASTENING CONDITIONS SHOWN BELOW

1 LAYER GYP. BD.	2 LAYERS GYP. BD.	MASONRY	GYP. BD. & MASONRY
<p>1/4"-20 X 2-3/4" BOLT AND TYPE BB TOGGLER BY MECHANICAL PLASTICS</p> <p>QTY:</p>	<p>1/4"-20 X 2-3/4" BOLT AND TYPE BB TOGGLER BY MECHANICAL PLASTICS</p> <p>QTY:</p>	<p>1/4" X 3" LAG SCREW AND TYPE AF6 ALLIGATOR ANCHORS BY MECHANICAL PLASTICS</p> <p>QTY:</p>	<p>1/4" X 3" LAG SCREW AND TYPE AF6 ALLIGATOR ANCHORS BY MECHANICAL PLASTICS</p> <p>QTY:</p>

SPECIFICATION:

GENERAL: FURNISH AND INSTALL BUMPER GUARD SYSTEM(S) BY ARDEN ARCHITECTURAL SPECIALTIES, INC., AS SHOWN AND SPECIFIED.

INSTALLATION: SECURE TO WALL OR PARTITION IN ACCORDANCE WITH MANUFACTURER'S PRINTED INSTRUCTIONS. USE FASTENERS DESIGNED AND APPROVED FOR PURPOSE INTENDED, SPACED 32 INCHES [812.8mm] O.C. MAX, UNLESS SPECIFIED OTHERWISE. INSTALL SYSTEM IN ACCORDANCE WITH ALL CODES HAVING JURISDICTION.



151 FIFTH AVE. NW SUITE J ST. PAUL, MN 55112-3268
TOLL-FREE 800.521.1826 TEL 651.631.1607 FAX 651.631.0251