

# Wallwear® Integrated Wall Protection Systems

FIRE PROOF CAULK #CP25WB  
AT BOTH SEAMS

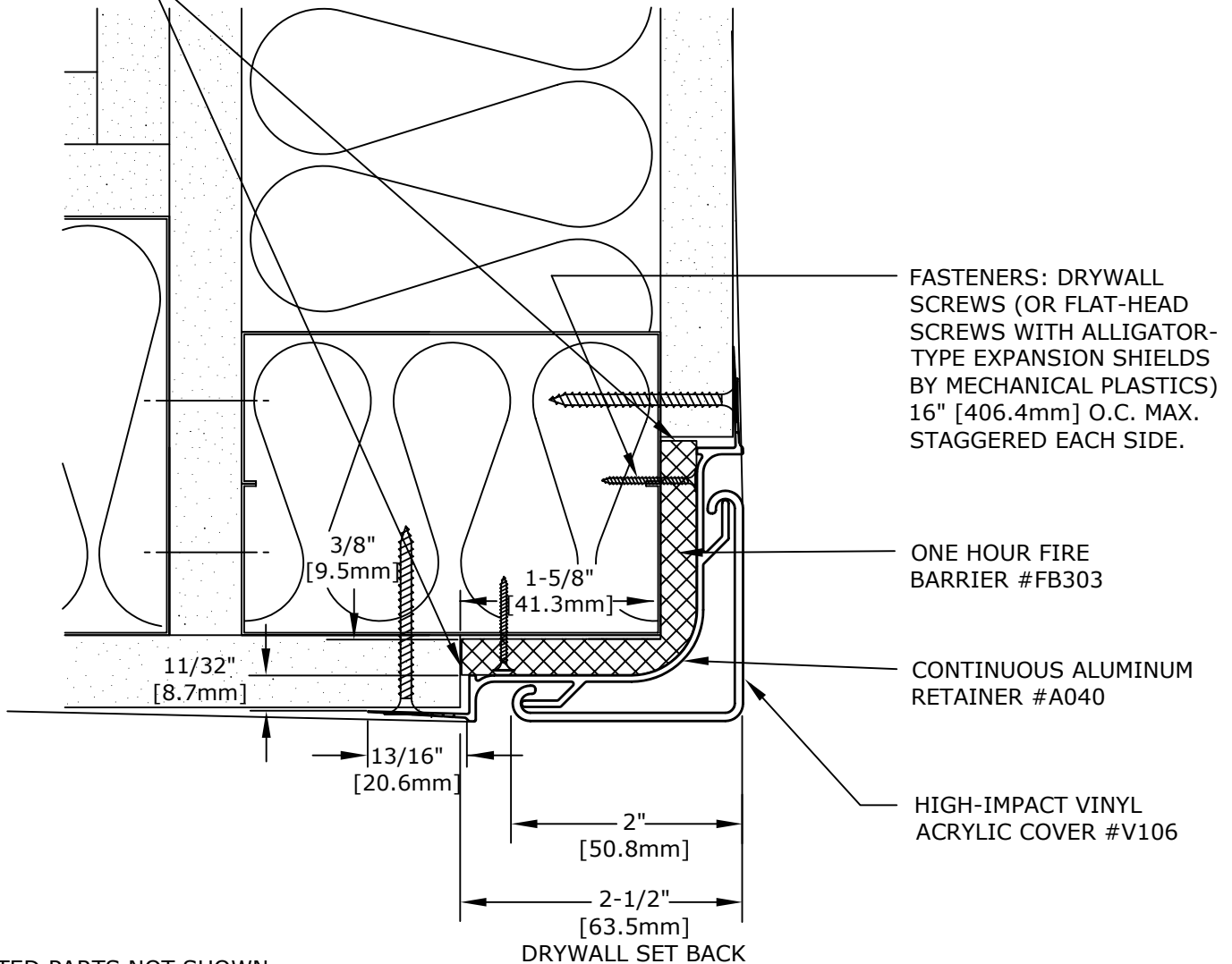

RELATED PARTS NOT SHOWN  
 ALUMINUM COVE BASE #A027 - 4"  
 [101.6mm] HIGH UNLESS OTHERWISE  
 SPECIFIED

## CGR-2S1 ONE-HOUR FIRE-RATED

IMPORTANT: USER SHALL VERIFY CONFORMANCE OF ALL CONSTRUCTIONS SHOWN WITH LOCAL CODES AND WITH REQUIREMENTS OF METAL STUD MANUFACTURER FOR RATINGS. FASTENERS AND PARTITION COMPONENTS NOT BY ARDEN ARCHITECTURAL SPECIALTIES, INC.

FIRE-RATED CORNER GUARDS		DATE:	SCALE:
<p><u>GENERAL SPECIFICATION</u></p> <p><u>RETAINER:</u> ALUMINUM ALLOY TYPE 6063-T5, MILL FINISH .062" [1.57mm] THICK</p> <p><u>COVER:</u> HIGH-IMPACT VINYL ACRYLIC, IN ACCORDANCE WITH ASTM D 4226 AND ASTM D 256, .078" [1.98mm] THICK</p> <p><u>CONTINUOUS LENGTH AVAILABLE:</u> 10' [3.05m] MAXIMUM</p>		<p>PROJECT:</p> <hr/> <p>ARCHITECT:</p> <hr/> <p>CONTRACTOR:</p> <hr/> <p>REPRESENTATIVE:</p>	



151 FIFTH AVE. NW SUITE J ST. PAUL, MN 55112-3268  
 TOLL-FREE 800.521.1826 TEL 651.631.1607 FAX 651.631.0251

CUSTOMER:	CUST. NO:	JOB NO:	SHEET OF
-----------	-----------	---------	----------