

STAINLESS STEEL CORNER GUARDS

MECHANICALLY FASTENED APPLICATION

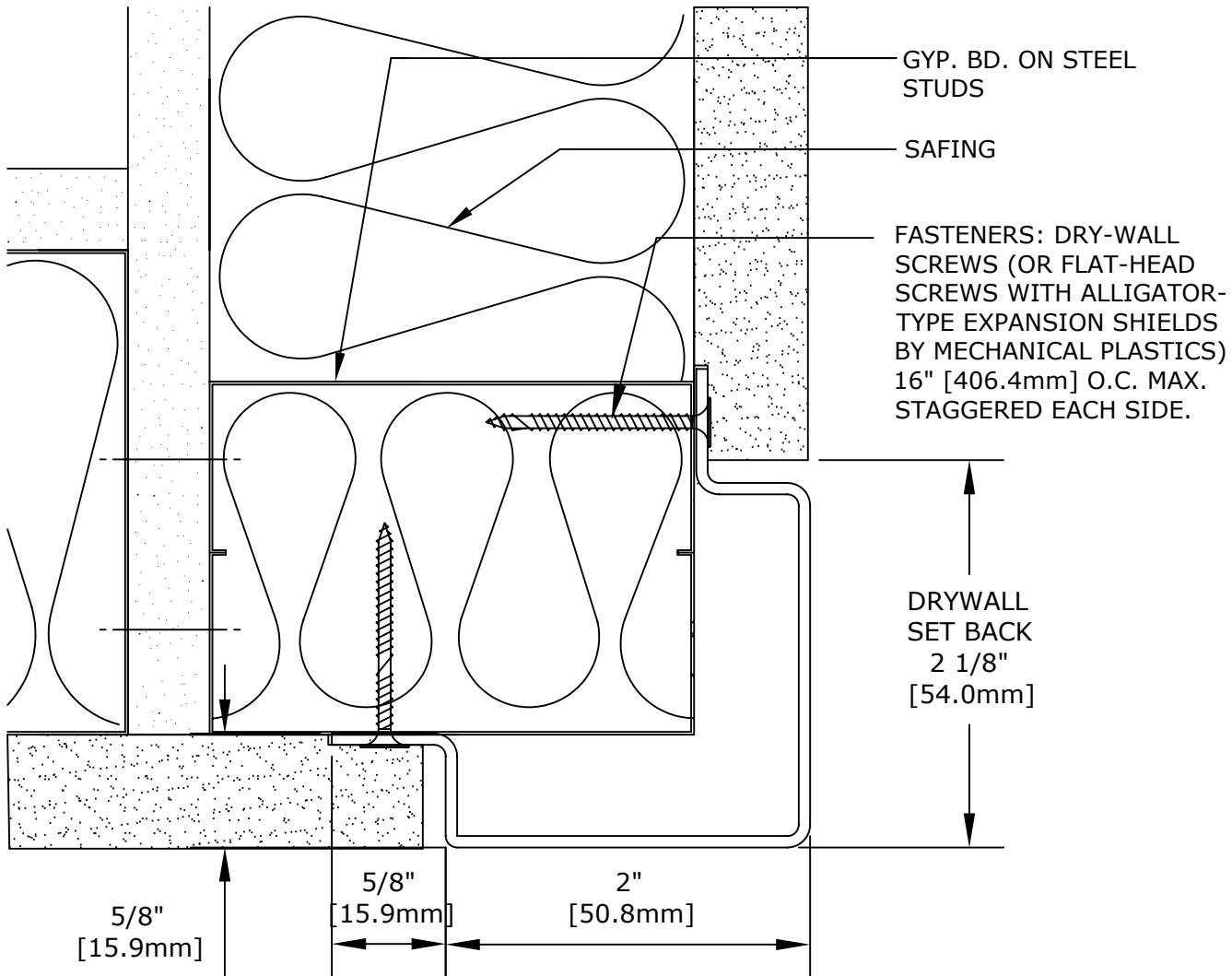

CORNER GUARD CGSS-F2

IMPORTANT: USER SHALL VERIFY CONFORMANCE OF ALL CONSTRUCTIONS SHOWN WITH LOCAL CODES AND WITH REQUIREMENTS OF METAL STUD MANUFACTURER FOR RATINGS. FASTENERS AND PARTITION COMPONENTS NOT BY ARDEN ARCHITECTURAL SPECIALTIES, INC.

CORNER GUARDS

DATE:

SCALE:

GENERAL SPECIFICATION

16 GA. STAINLESS STEEL, SATIN NO. 4 FINISH, WITH ROUNDED EDGES AND PROTECTIVE COATING

CONTINUOUS LENGTH AVAILABLE: 10' [3.05M] MAXIMUM

PROJECT:

ARCHITECT:

CONTRACTOR:

REPRESENTATIVE:

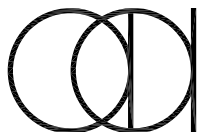

Arden
Architectural
Specialties, Inc.™

151 FIFTH AVE. NW SUITE J ST. PAUL, MN 55112-3268
TOLL-FREE 800.521.1826 TEL 651.631.1607 FAX 651.631.0251

CUSTOMER:

CUST. NO:

JOB NO:

SHEET OF